

Snow Pad

User Manual



V1.3
ZOOMAX

Name: Portable Electronic Video Magnifier

Model: Snow Pad

Intended Use:

The Portable Electronic Video Magnifier is used to help people with presbyopia and low vision more easily read materials to help them work, live and study

Patient Population:

People with presbyopia and low vision

Storage:

Temperature: 0°C~40°C

Humidity: <70%

Others: Need to be in a dry, dark, clean, ventilated, non-corrosive gas environment

ZOOMAX Technology Co., Limited
9F, Building D, Paradise Software Park, No.3 Xidoumen
Road, Xihu District,
Hangzhou, China 310012

Copyright© 2019 ZOOMAX Technology Co., Limited. All Rights Reserved. ZOOMAX® is a trademark of ZOOMAX Technology Co., Limited in the United States and other countries. Information in this document is subject to change without notice. No part of this publication may be reproduced or transmitted in any forms or by any means, electronic or mechanical, for any purpose, without the express written permission of ZOOMAX.

Contents

| | |
|--|----|
| User Manual | 1 |
| 1. Introduction and Usage | 1 |
| 2. Safety and Care | 1 |
| 3. Get to Know the Snow Pad | 2 |
| 3.1 What's in the Box | 2 |
| 3.2 Snow Pad Overview | 2 |
| 3.3 Unfold the Snow Pad | 3 |
| 3.4 The Optical Zoom Camera | 4 |
| 4. Use With A Tablet | 6 |
| 4.1 Recommended tablets | 6 |
| 4.2 Fix/Remove Tablet | 6 |
| 4.3 Connect the Device With the Tablet | 7 |
| 4.4 Power on/off | 7 |
| 5. Download SnowPad APP | 8 |
| 5.1 Home Page 1 | 9 |
| Split Screen Between APPs | 10 |
| Magnification Range | 14 |
| Zoom in & out | 14 |
| Panning | 14 |
| Mirror Image Correction | 14 |
| Snow Pad Camera Battery | 15 |
| Snap | 15 |
| Freeze | 15 |
| Recent | 15 |
| OCR/Text-to-Speech | 15 |
| Color Mode | 15 |
| Contrast Value Adjustment | 16 |
| Find | 16 |
| Camera Mode Change | 17 |
| More | 19 |
| 5.2 Home Page 2 | 19 |
| Detail View | 20 |
| Selfie | 20 |

| | |
|---------------------------------------|----|
| Reading Line | 21 |
| File Folder | 21 |
| Settings | 21 |
| Focus Lock | 22 |
| Back | 22 |
| 5.3 Image Review & OCR/Text-to-Speech | 22 |
| Image/Text | 23 |
| Read | 23 |
| Speed | 23 |
| Partition | 24 |
| Change Direction | 24 |
| Edit | 24 |
| Color Mode | 24 |
| 5.4 Image Edit | 25 |
| Exit | 25 |
| Save | 25 |
| Revoke | 25 |
| Change Direction | 26 |
| Brush | 26 |
| Color Mode | 26 |
| Cutting | 26 |
| Blurred | 27 |
| 5.5 File Folder | 27 |
| 5.6 Settings | 28 |
| 6. Software Update | 34 |
| 7. Specifications | 35 |
| 8. Trouble shooting | 35 |
| 9. Service and Support | 36 |
| 10. Certification and Compliance | 37 |

1. Introduction and Usage

Thank you very much for choosing Snow Pad, an all-in-one portable electronic magnifier from Zoomax. We are committed to provide you with high-quality images, more comfortable experience, larger reading and writing area, using 7x HD optical zoom lens, stable bracket, and very easy to use. Snow Pad can be used in office conference room as well as school. As always, Zoomax hopes to help you have a more enjoyable visual experience in your work as well as life.

Please read this user guide carefully. This guide will help you better understand the features of Snow Pad.

We constantly seek to improve our products. Therefore, it is possible that this guide is not the latest version available. You can download the latest user's guide in the Technical Support section at www.zoomax.com

2. Safety and Care

To maintain Snow Pad in optimal condition:

- To avoid risk of fire, do not expose Snow Pad to excessive heat or direct sunlight.
- Recommended for use in temperatures between 0° C and 35° C. (32°F and 95°F).
- To avoid the risk of electrical damage, keep Snow Pad away from fluids and chemicals.
- To avoid the risk of electrical shock, do not attempt to disassemble the unit. Please refer service requests to Zoomax or an authorized repair facility.
- Always unplug the Snow Pad before cleaning. Use a cleaning cloth or a soft damp cloth to clean the exterior.
- Please do not charge the device with adapters and cables other than the accessories. And also do not use the device's adapter

and cable to charge other electronic devices.

3. Get to Know the Snow Pad

3.1 What's in the Box

You will find the following items inside the Snow Pad package box:

- Snow Pad device x1
- Backpack x1
- Power adapter x1
- Charging cable x1
- Type-C connecting cable x1
- Lightning connecting cable x1
- Magnetic sheet x2
- Cleaning cloth x1
- User manual x1
- Writing board x1

3.2 Snow Pad Overview

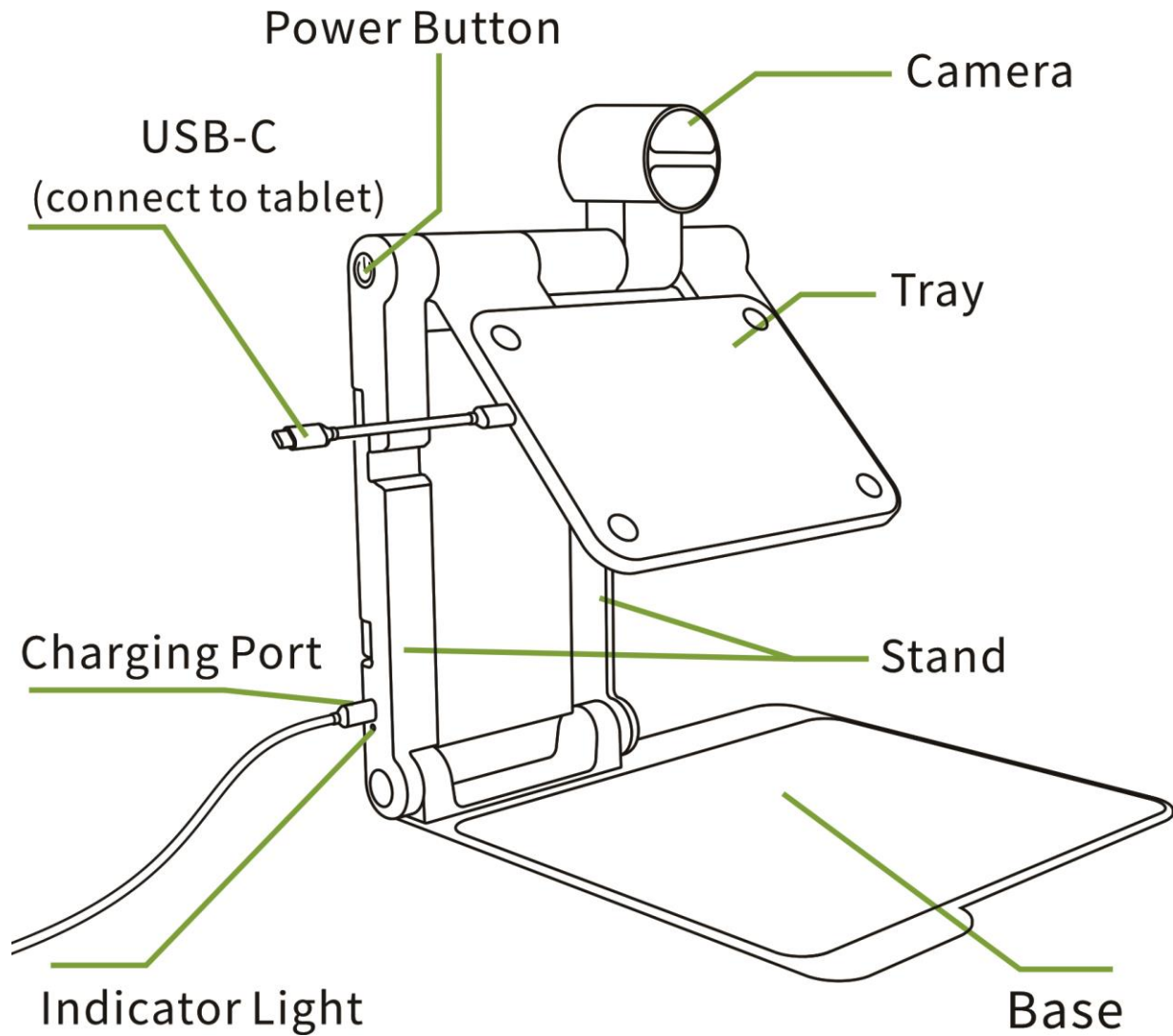

3.3 Unfold the Snow Pad

Hold the base with one hand and lift the crossbar (not the camera) upward with the other hand to unfold the device.

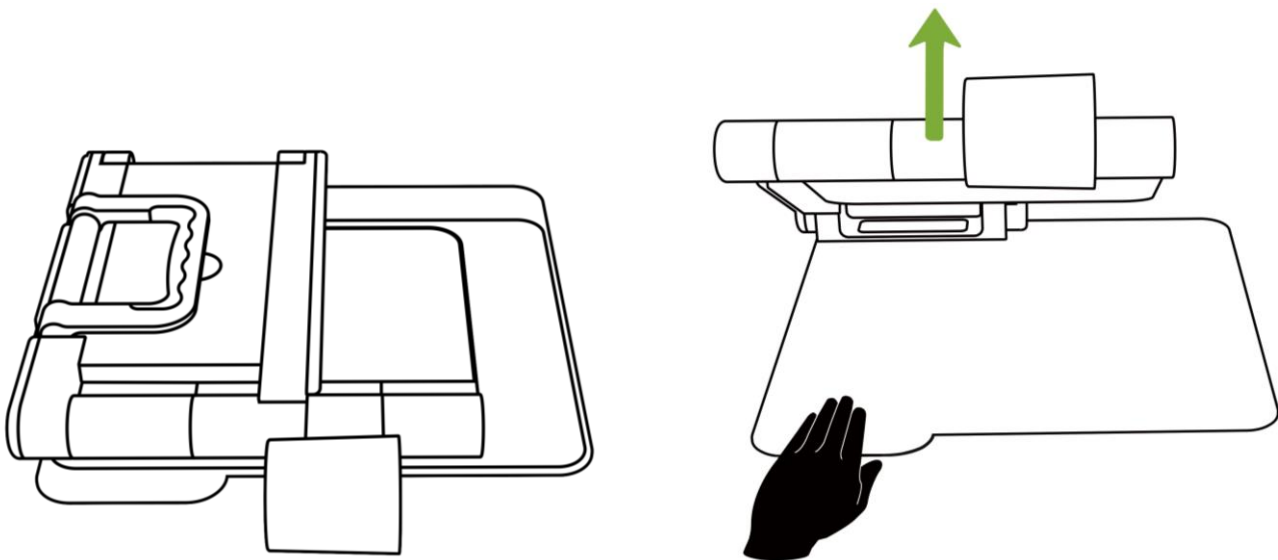

3.4 The Optical Zoom Camera

Turn 270 degrees clockwise and 60 degrees counterclockwise.

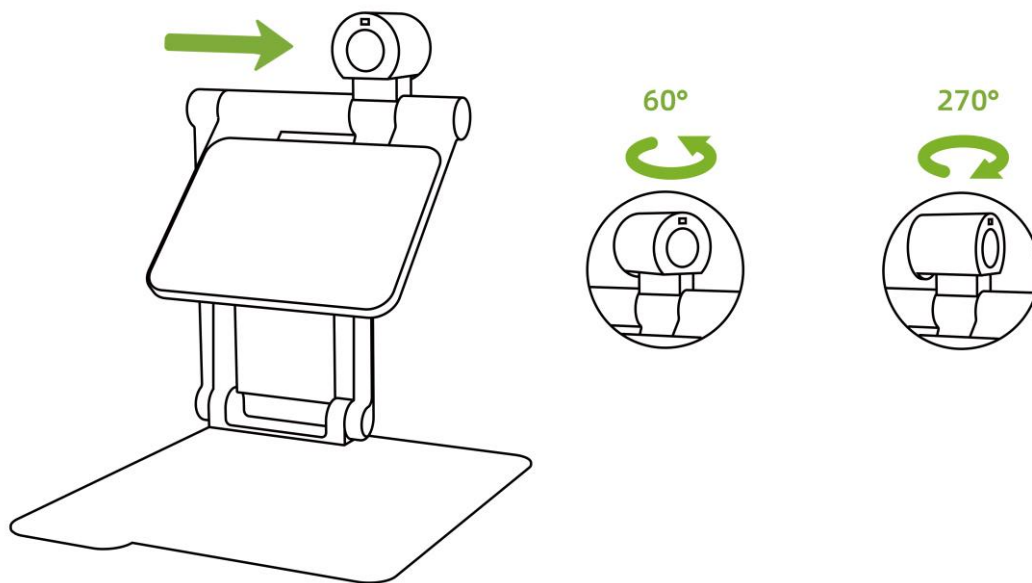

Turn 15 degrees up and 40 degrees down (when camera at distance view position).

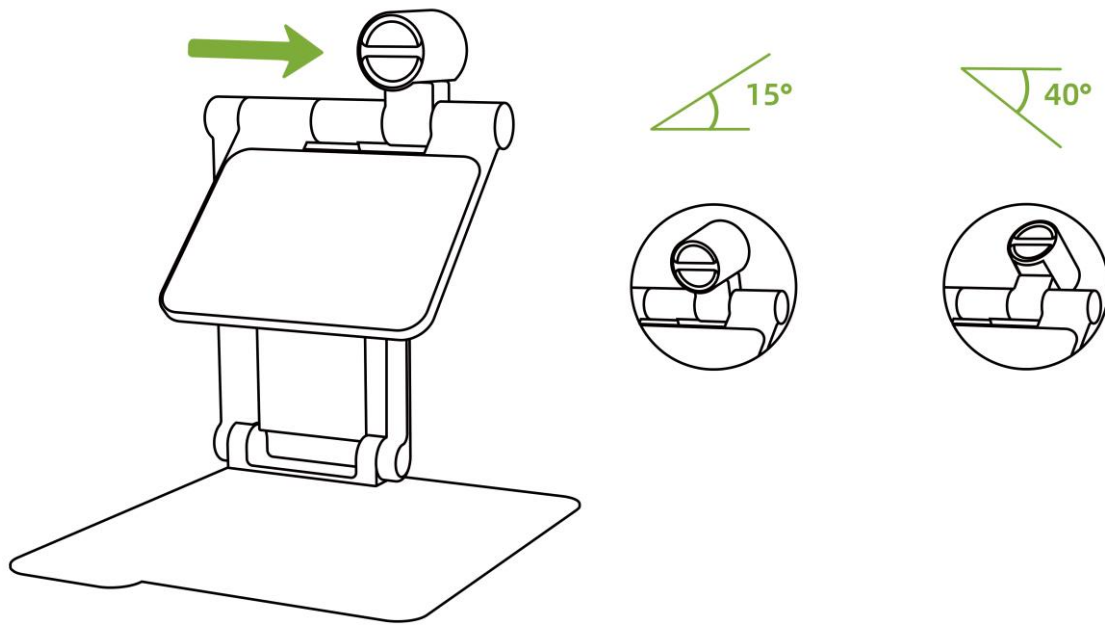

3.5 Charge the Battery

- Plug the charging cable into the charging port as shown in the figure below.
- Indicator color: Yellow when charging ; green when fully charged.

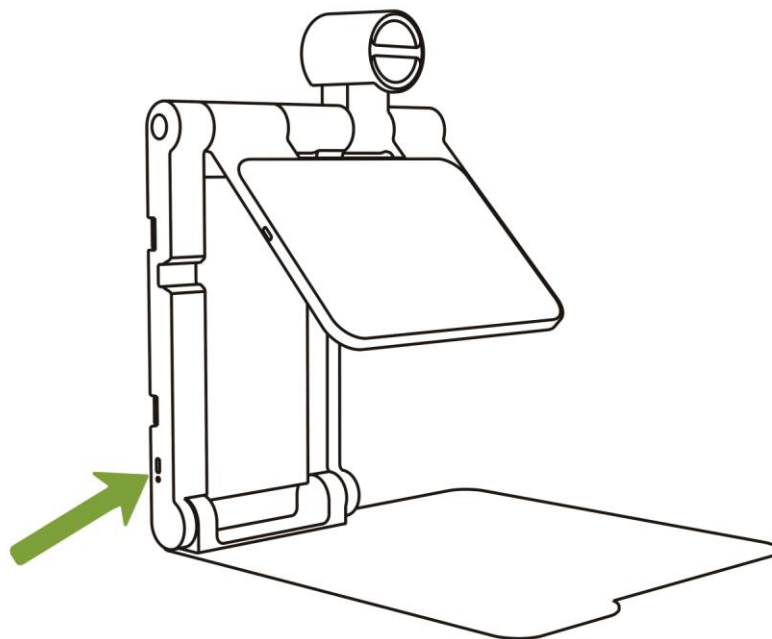

- It takes 4.5hours for Snow Pad to be fully charged and it can be used continuously for 5hours. When the battery is low, the tip

icon appears on the screen. Please recharge the battery to avoid the device turns off unexpectedly.

4. Use With A Tablet

4.1 Recommended tablets

- iPad, iPad Air, iPad Pro, running iPadOS 16 or higher.
- Xiaomi Pad 6, Xiaomi Pad 6 Pro, running Android 8 or higher.

4.2 Fix/Remove Tablet

- Stick the magnetic sheet to the center of the back of the tablet(or it's protected case), and wait about 15 minutes before putting it on the tray.

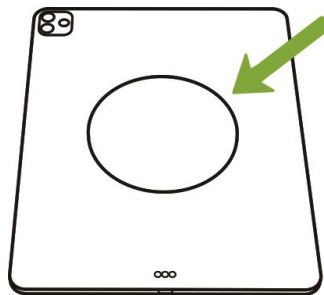

- Always make sure the tablet's camera is not blocked by the tray.

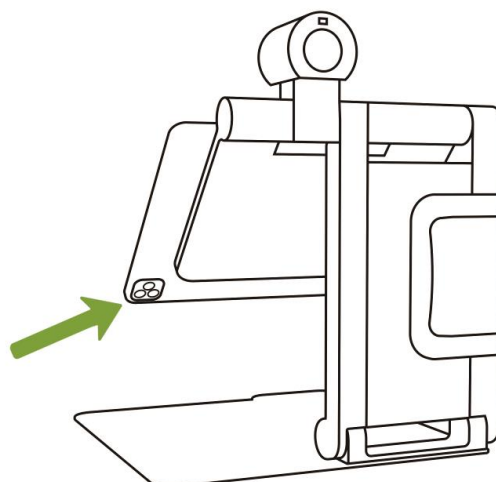

- Hold the lower end of the tablet and slide it horizontally along the tray to remove it

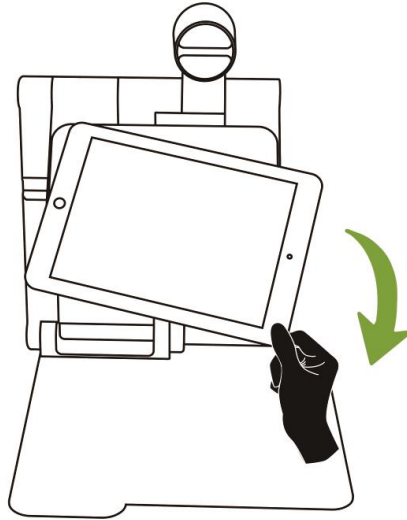

4.3 Connect the Device With the Tablet

- Place the tablet horizontally on the tray with the interface on the left side.
- Use the short connection cable provided to connect the Type-C port on the left side of the tray to the charging port on the tablet. Generally, a C to C connection cable is used, but some iPads require a C to Lightning connection cable.
- If the connection is not successful, the screen will display a connection failure message.

4.4 Power on/off

- Long press the power button for 2s to turn on/off the device and when the device is on, the button light will be green.

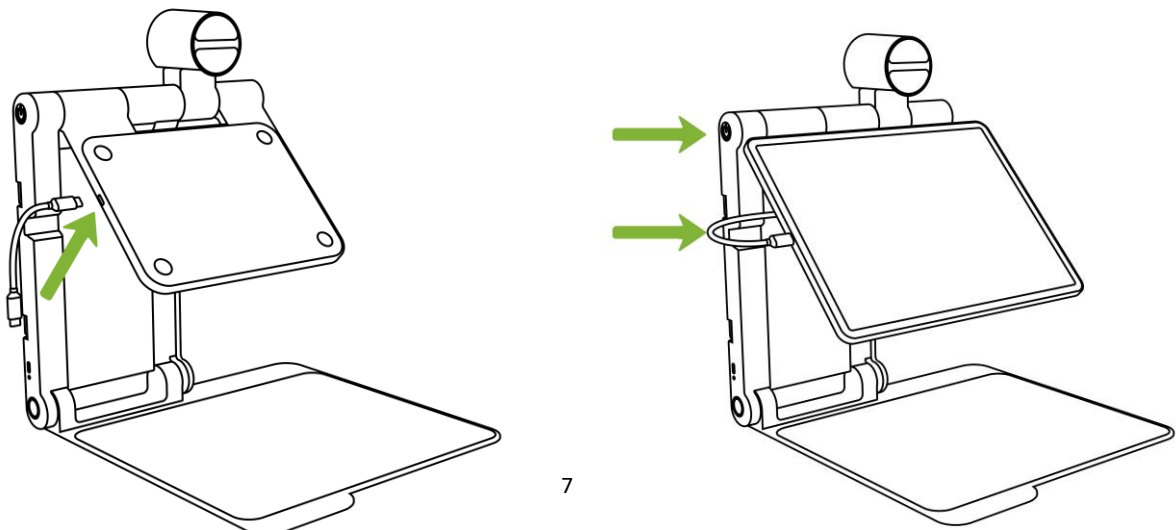

5. Download SnowPad APP

- For iPadOS, please search “Snow Pad” in APP Store or scan the QR code below to download it.
- For Android system, please download the installation package from our official website <https://www.zoomax.com/> or scan the QR code below to download it.



iPadOS



Android

Please note that the APP works only in the condition of your tablet being connected with Snow Pad.

Followings are the APP's main functions. You can find more introduction in Demo videos in:

Zooamx official website: www.zoomax.com

Zoomax YouTube account: www.youtube.com/@ZooMaxmagnifier

5.1 Home Page 1

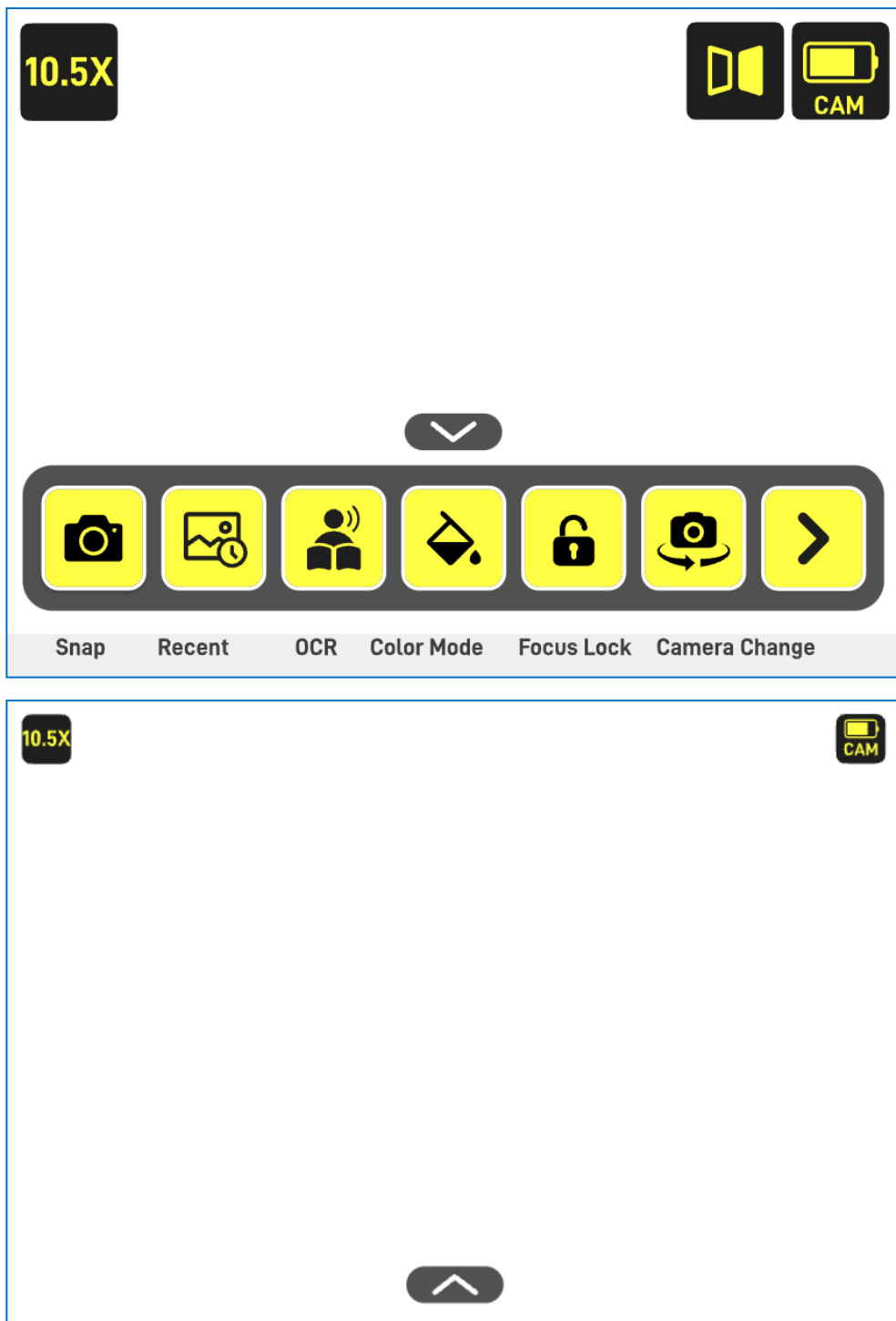

The dock at the bottom of the screen automatically hides after 5s of inactivity. Touch anywhere on the screen to bring it up again. You can also hide and wake up manually by touching the icon  above the dock.

● Split Screen Between APPs

Snow Pad APP supports simultaneous use with other APPs in split screen. Tap the three dots or the short bar at the top center of the screen to see different screen options. Select Split Screen or Split View, then open another APP you want to use.

When using split-screen with other APPs, you can switch between camera views by lightly touching the middle of the left edge of the Snow Pad APP page with two fingers.

❖ Please note that some APPs do not support split screen.

Below are examples of split-screen on the tablet we recommend using.

--iPad/iPad Air/iPad Pro:

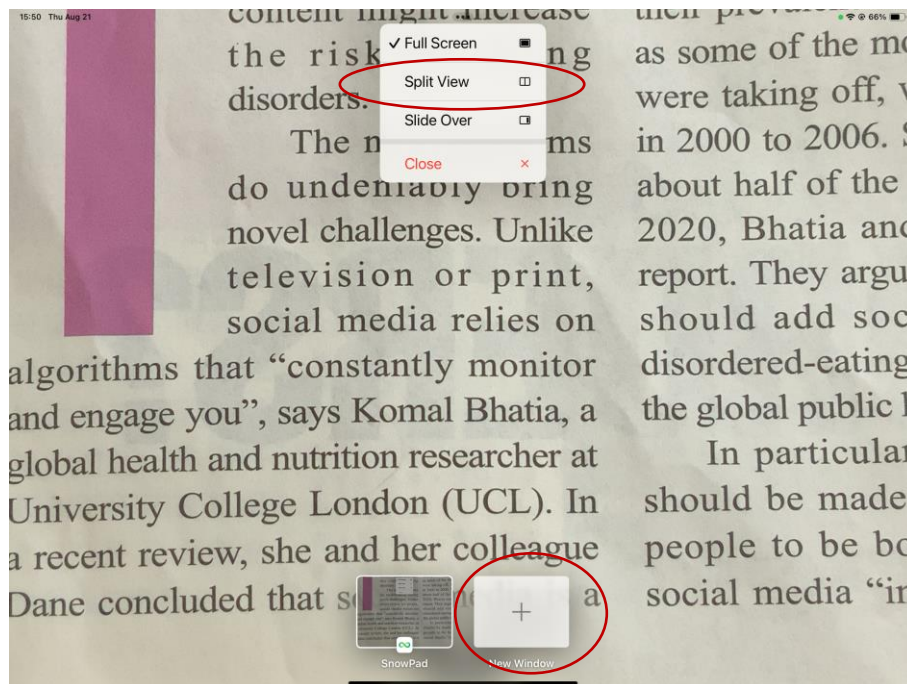

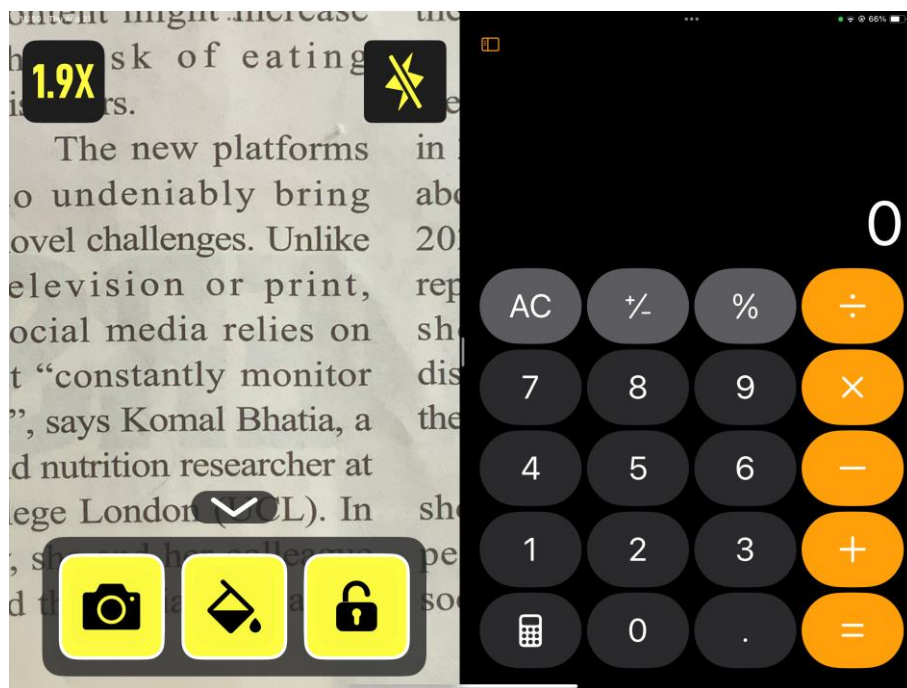
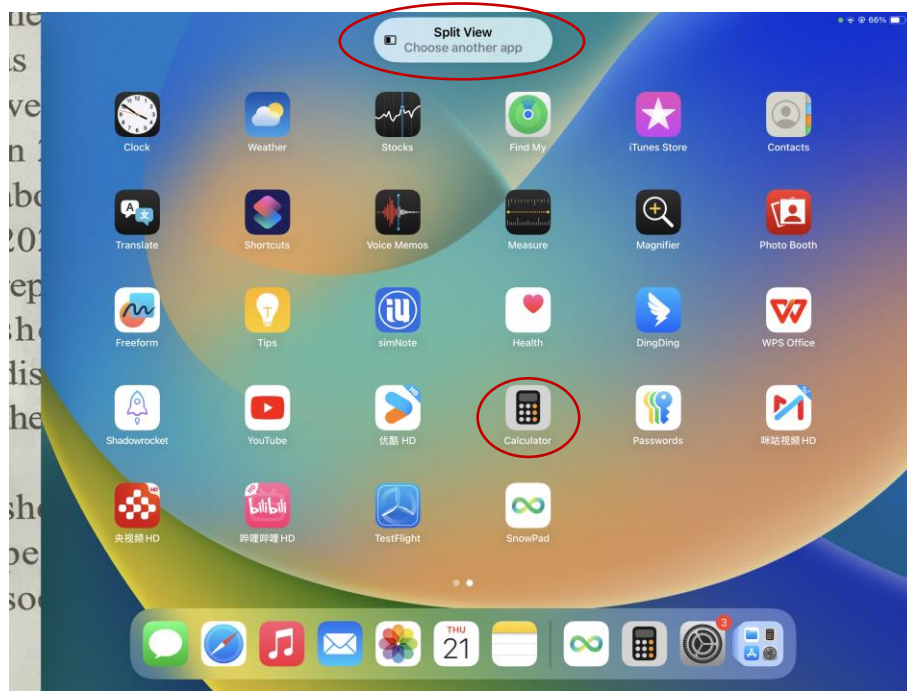

--Xiaomi Pad:

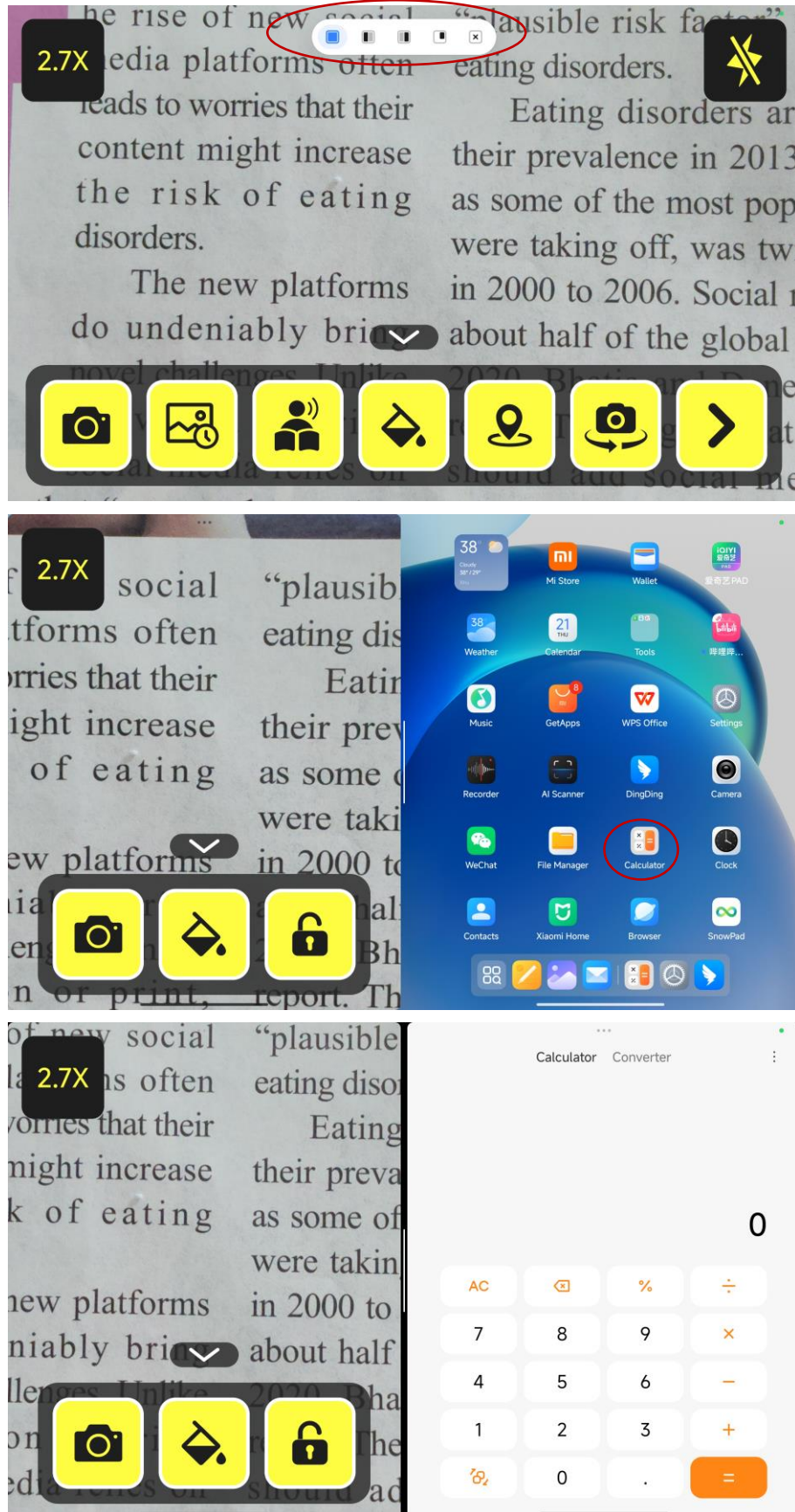

--SamSung tablet:

If you cannot find the short bar at the top of the screen, go to the

tablet system settings - advanced features - labs-enable the multi window.

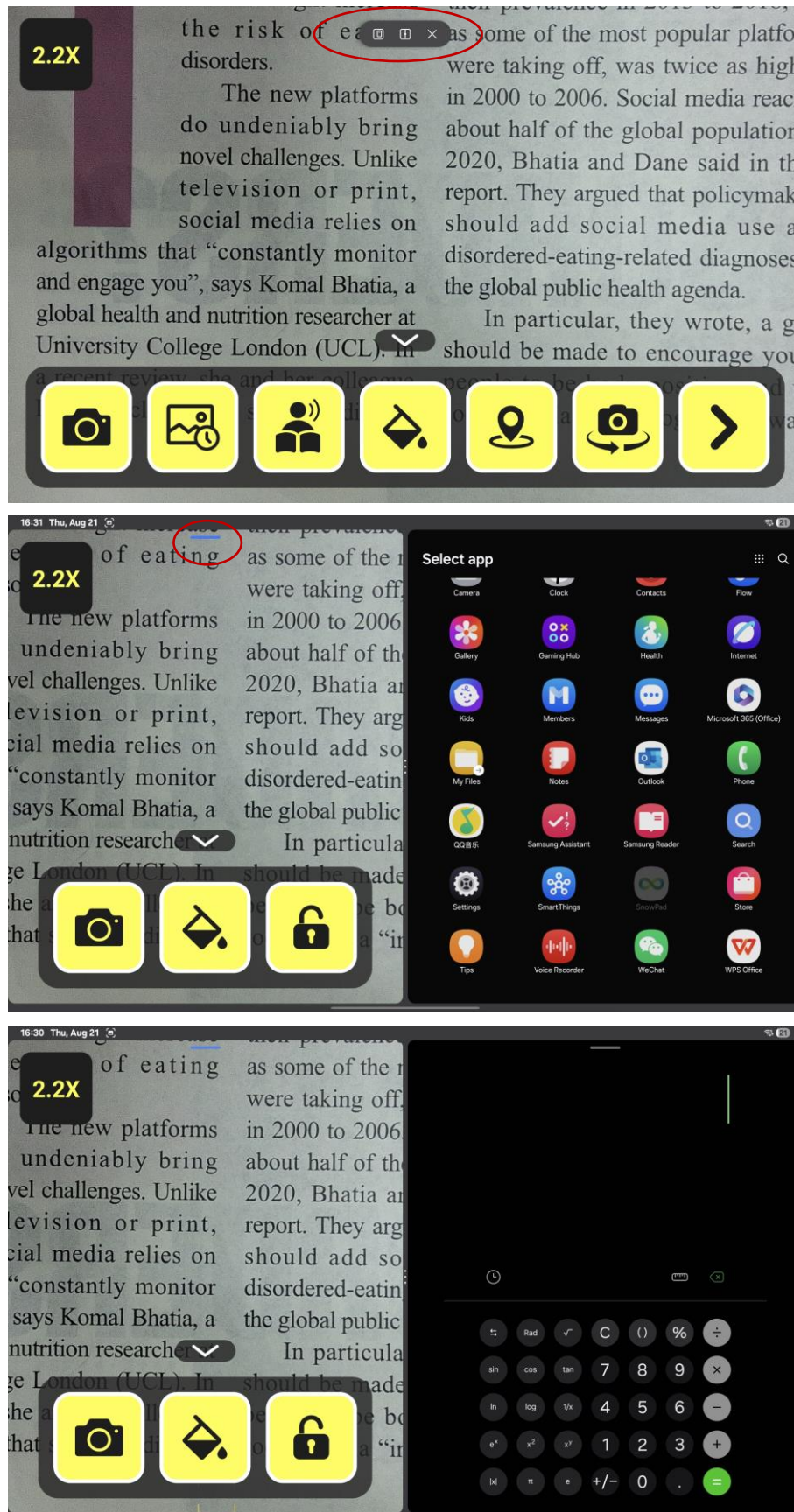

- Magnification Range



Displays real-time magnification, from 1-32x.

- Zoom in & out

No icon but shortcut.

Pinch or unfold both fingers to adjust magnification.

- Panning

No icon but shortcut.

-- Image panning: When the magnification times $> 1x$, use one or two-finger touch to pan the image.

-- Live panning:

① Distance view camera: Two-finger touch panning when the magnification times $> 7x$;

② Near view camera: Two-finger touch panning when the magnification times $> 1x$.

- Mirror Image Correction



Tap the icon for mirror image correction, especially when looking at yourself with the optical zoom camera.

- Snow Pad Camera Battery



Displays remaining battery of the Snow Pad Camera

- Snap



Tap the icon to take an image and it saves automatically.

- Freeze: When using split screen within the APP, press and hold the snap button for 1 second to freeze the screen. And short press it again to unfreeze.

- Recent



Tap the icon to view the latest saved image or file.

- OCR/Text-to-Speech



Tap the icon to start. Please lay the reading material as flat as possible, as this will improve the recognition rate and accuracy.

- Color Mode



Tap the icon to change the color mode, and hold this icon for 1s can go back to true color directly. It has 10 kinds of high contrast colors totally which can be enabled or disabled in Settings.

- Contrast Value Adjustment

No icon but shortcut.

In high-contrast color mode, slide one finger up and down on the right edge of the screen to adjust the contrast value until you see the image clearly..

- Find



Find function is for easily localizing the zoom in area. It only effects when the magnification time $> 1x$. Tap the Find you on the screen to enter. A red frame appears. Tap again, the screen goes back to previous magnification time and the red box disappears.

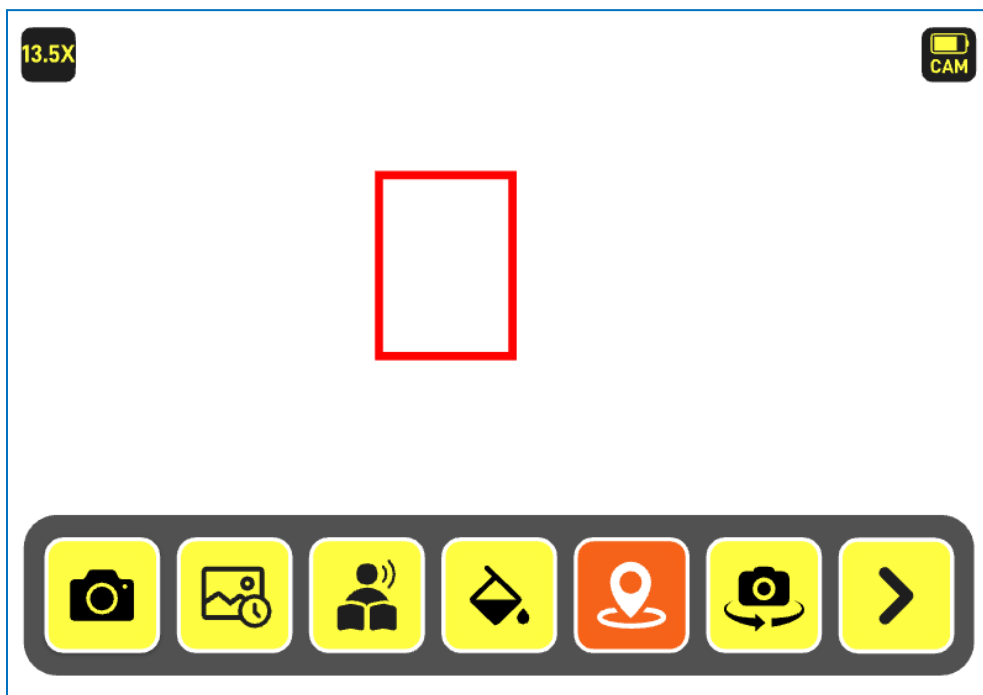

● Camera Mode Change



Tap the icon to change. The sequence of screen change is: full screen of distance-view → full screen of near-view → left and right split screen → up and down split screen.

When splitting the screen, click on the switch icon in the center to switch the two screens' position.

Shortcut: Tap gently with two fingers on the center of the left edge of the screen also enables the camera mode change.

Full screen of near-view

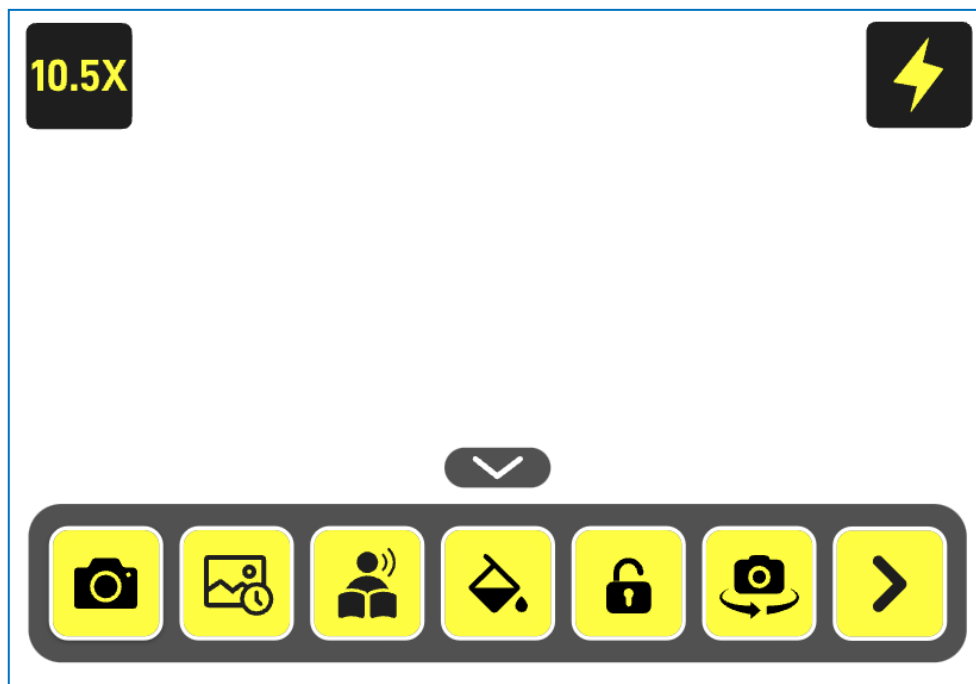

For some tablets that come with a flash, you can tap this

icon to turn on the tablet's flash when looking near view.

Split screen: up and down

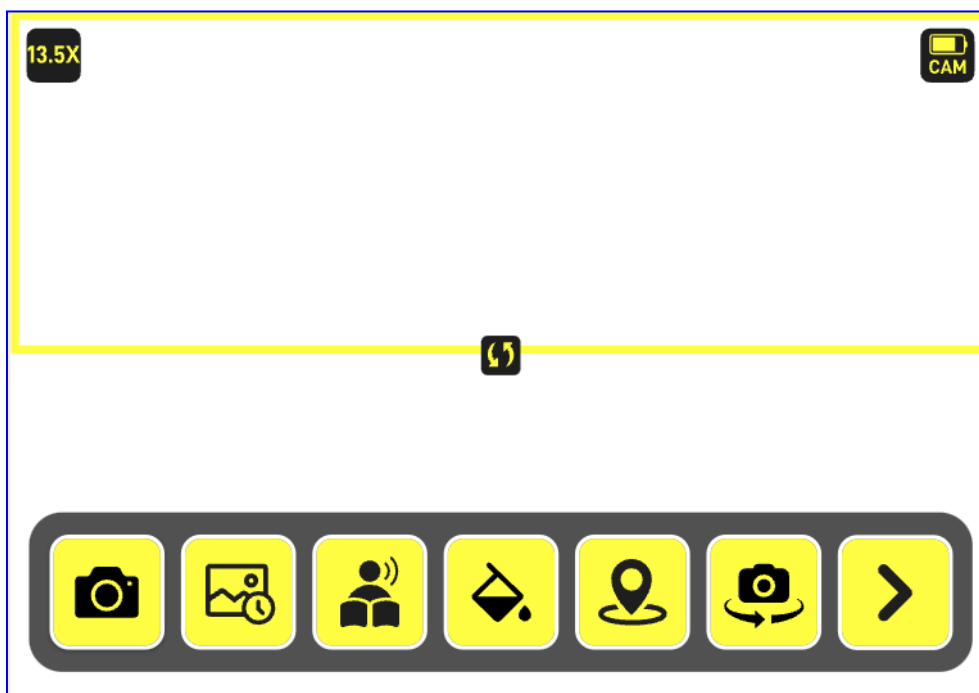

Split screen: left and right

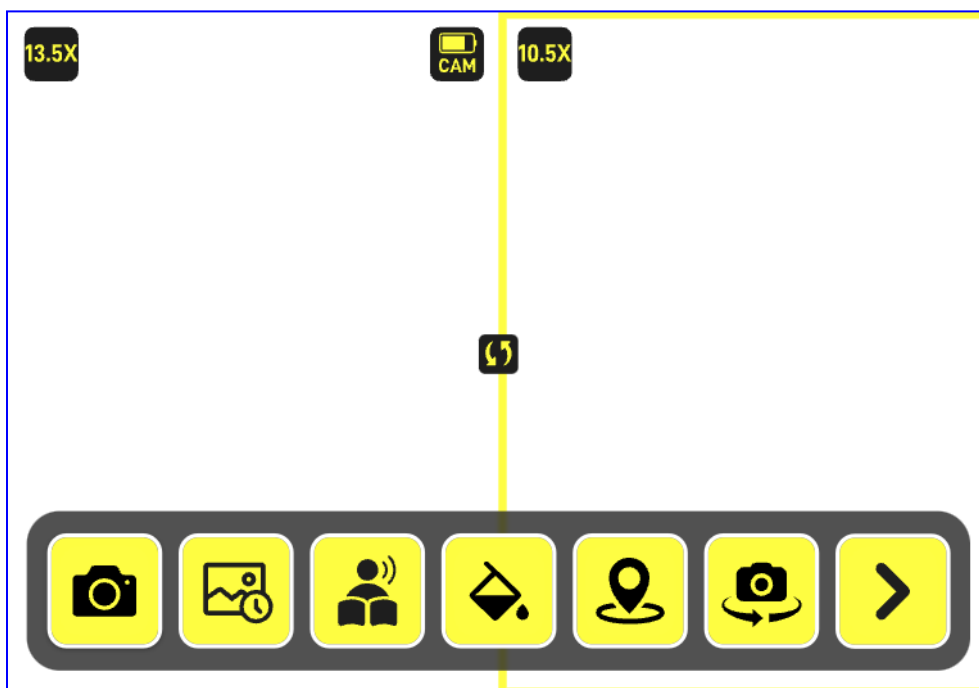



Put your finger on this icon and drag it up/down or right/left to adjust the size of the screens.

- More



Tap the icon to expand more function icons, and goes to Home page 2.

5.2 Home Page 2

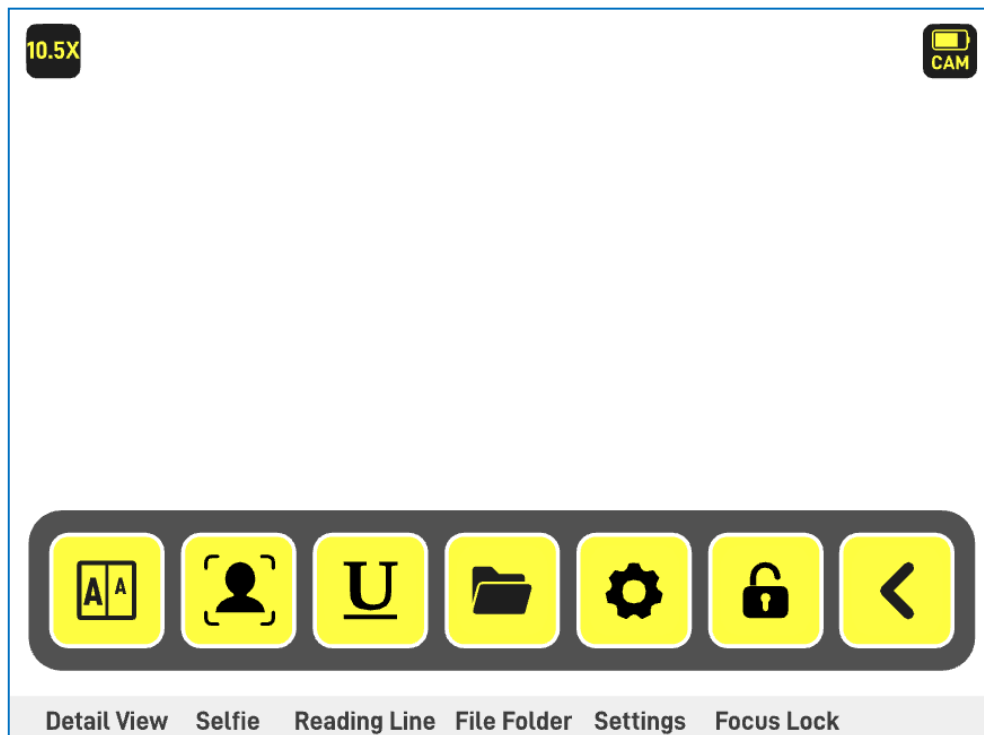

● Detail View



Tap the icon, the screen is divided into left and right parts, the magnification in the left side is approximately 3 times larger than the right side. There is a red frame in the right side. Place your reading material under the camera, drag the red frame with your finger to where you want to view, and then you see it was enlarged in the left side.

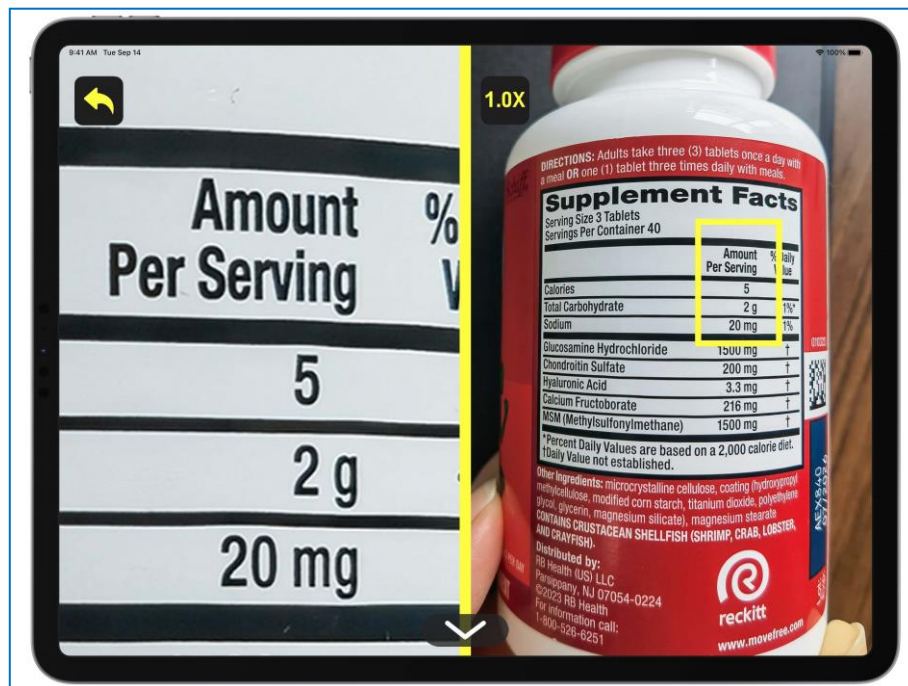

● Selfie



Tap the icon, the screen changes to the front camera of the tablet, so you can take a selfie, or apply make-up.

- Reading Line



Tap the icon to call out the 5 kinds of reading line or mask that you can choose one prefer, and the reading line/mask can be moved in the screen. Moreover, there are 6 types of reading line color for your choice in Setting.

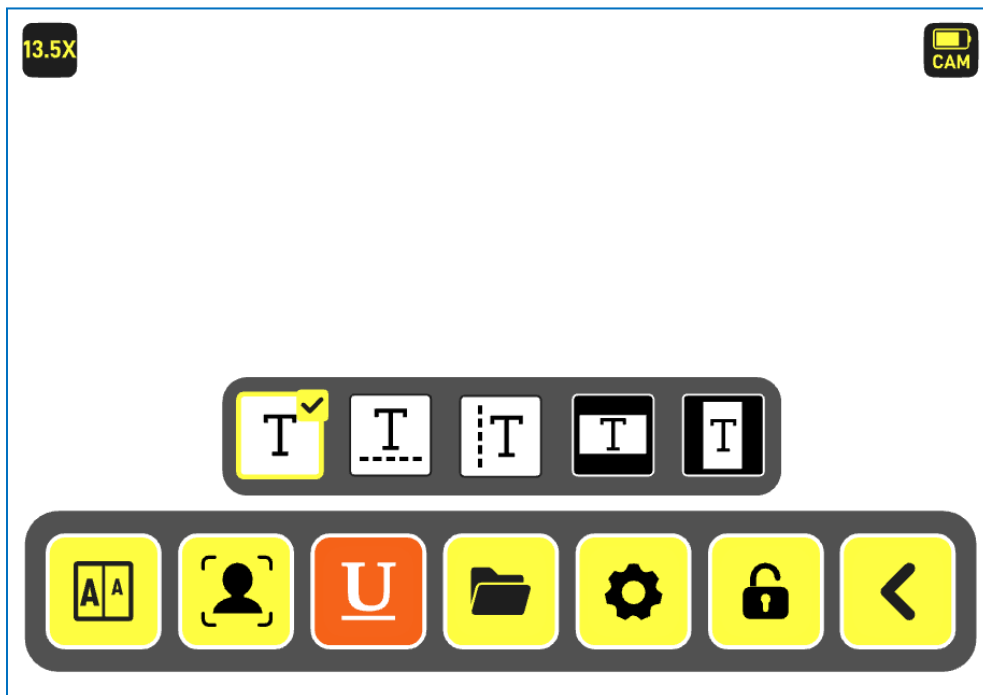

- File Folder



Tap the icon to open the folder(see 5.5).

- Settings



Tap the icon to enter into the settings page(see 5.6).

- Focus Lock



Tap the icon to lock or unlock the focus of the cameras. When being locked, the image will not focus repeatedly at the same distance, which is ideal for writing or looking far in the classroom.

- Back



Tap the icon to collapse the expand icons and go back to Home page 1.

5.3 Image Review & OCR/Text-to-Speech

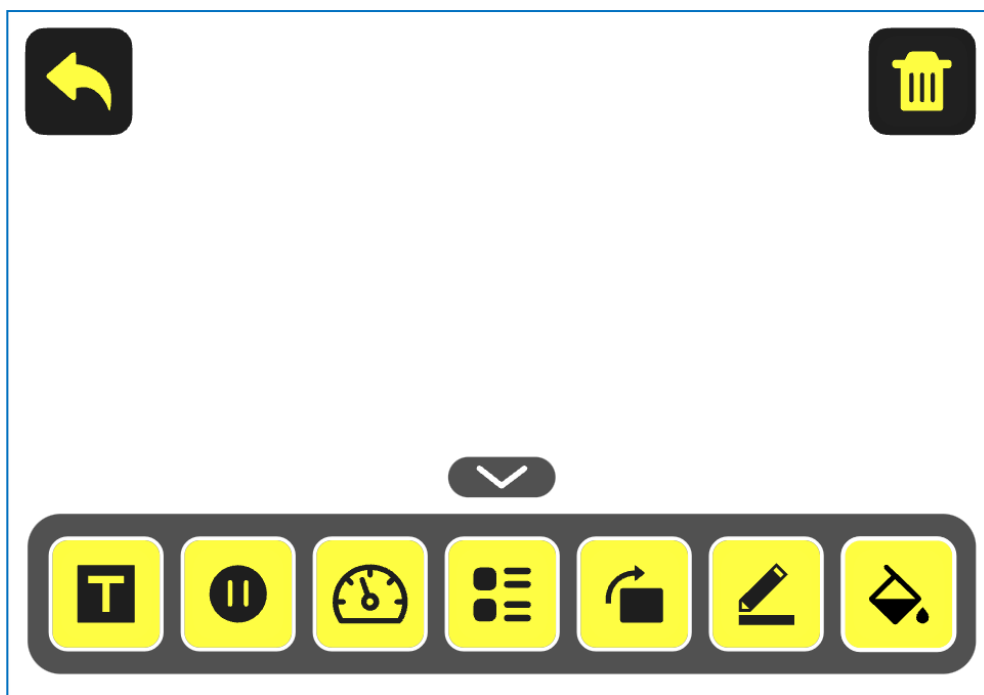

- Image/Text



Tap the icon to switch between the image mode and text mode.

- Read



Tap the icon to start the text-to-speech.

- Speed



Tap the icon to choose the reading speed.

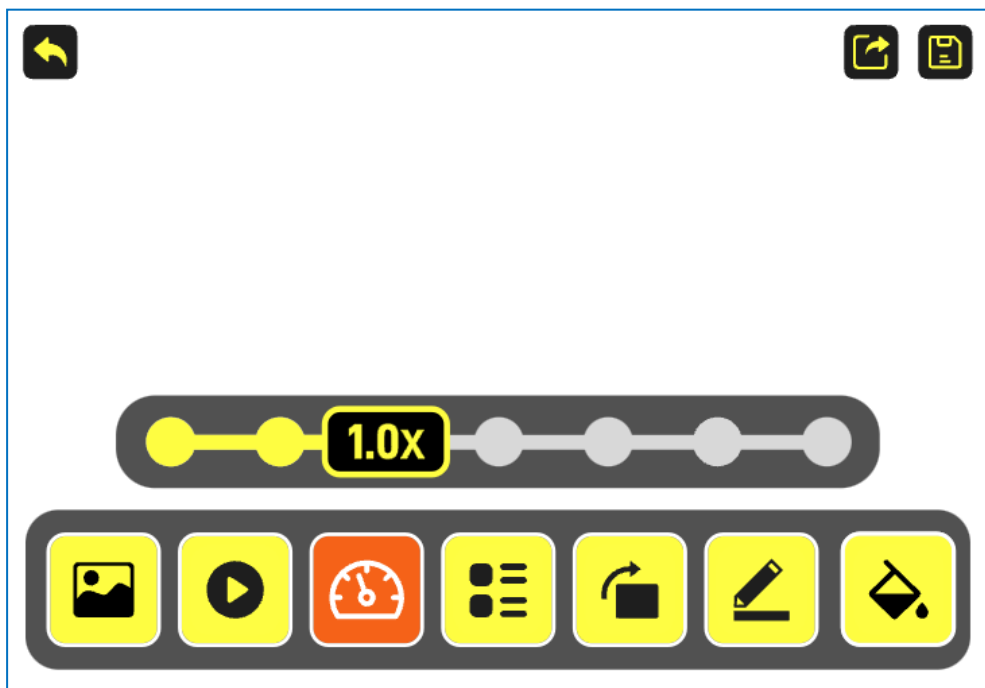

● Partition



Under the image mode, click the icon to change the partition mode to make the reading area more clear, and there are total 3 different modes:

① No Partitioning



② partitioning by paragraph



③ partitioning by line



● Change Direction



Tap the icon to convert the image 90 degrees clockwise.

● Edit



Tap the icon to enter the image edit page(see 5.4)

● Color Mode



Tap the icon to change the color mode.

5.4 Image Edit



- Exit



Tap the icon to exit the edit page and back to image view page.

- Save



Tap the icon to save the image to file folder.

- Revoke

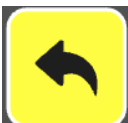

Tap the icon to revoke operation and return to the last step.

- Change Direction



Tap the icon to convert the image 90 degrees clockwise.

- Brush



Tap the icon to change the colors of brush.

Long press the icon to open all options, including four colors and three brushes.

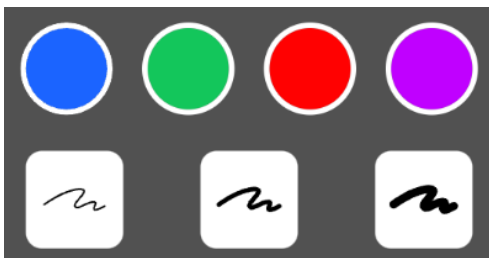

- Color Mode



Tap the icon to change the color mode.

- Cutting



Tap the icon to enter the cutting mode and the cutting box can be moved.



- Blurred

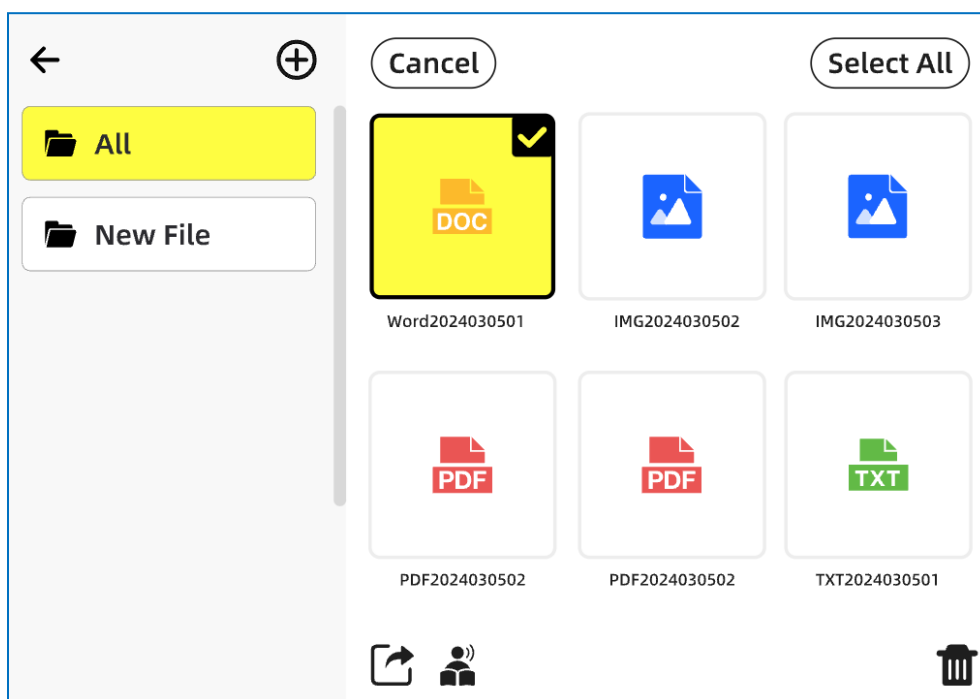

Tap the icon and then one-finger painting of a picture can blur the area.

5.5 File Folder



- APP comes with an initial folder **ALL** that contains all the images and documents, arranged in chronological order of saving, with the newest one displayed at the top.
- You can build new folders by clicking the plus icon  and name it as you like.
- Select some images or select all, delete or share them, or move them from one folder to another.
- After selecting one or more photos, click the OCR icon  in the

lower left corner to OCR or Text-To-Speech.

5.6 Settings

- Basic Mode: When you turn on the basic mode, the main page will keep a maximum of 6 function icons. This is to make it easier to use and reduce learning costs. Except for the settings which are fixed on the main page, the other few can be chosen by you. And, the order in which these icons are placed can also be set by you.

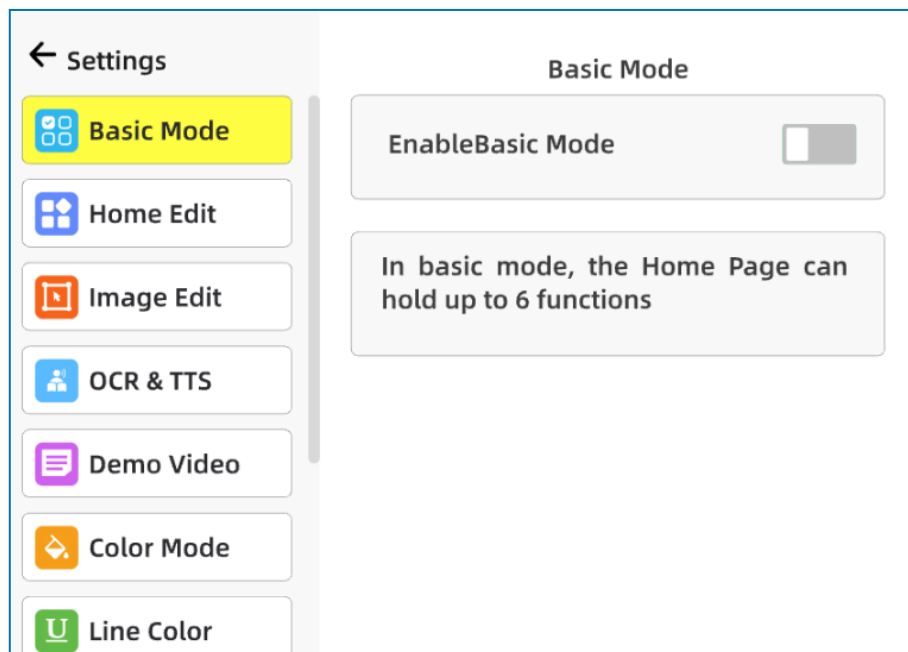

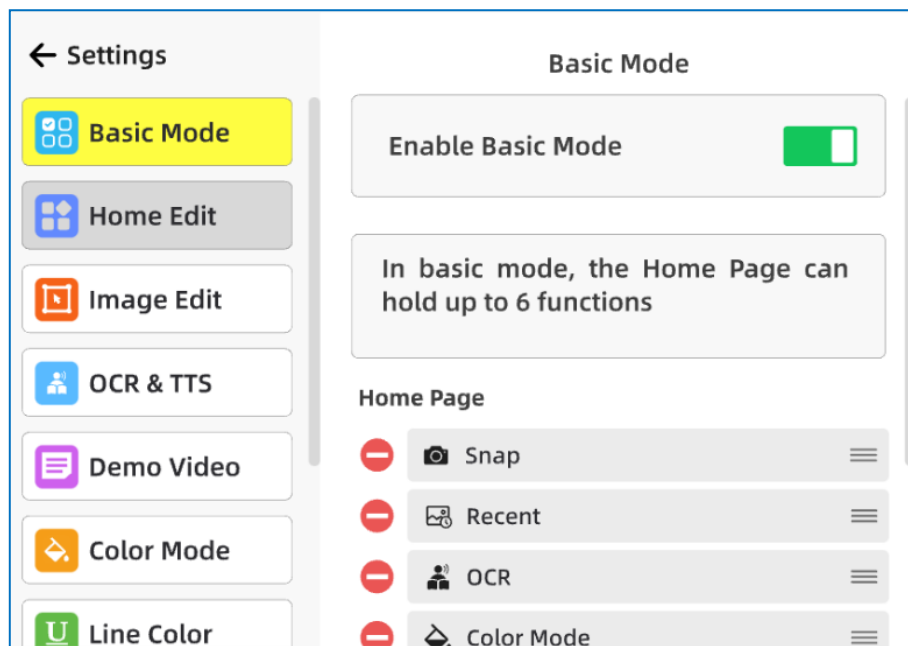

- Home Edit: Long press the right icon and drag it up and down to move the position of the icon, and then the icon on the home page will be changed accordingly.

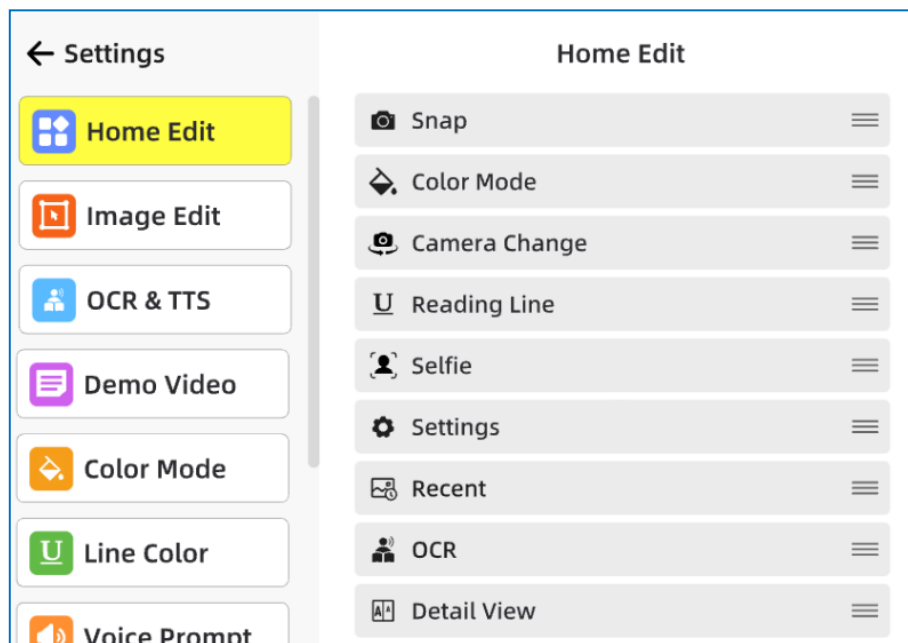

- Image Edit: Long press the right icon and drag it up and down to move the position of the icon, and then the icon on the image view page will be changed accordingly.

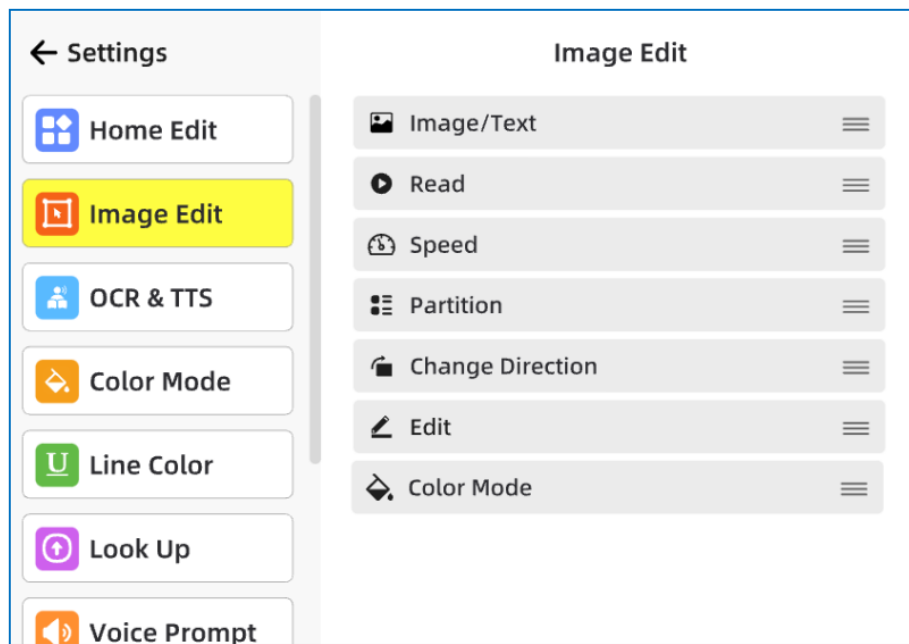

- OCR & TTS: Choose the language, set the volume and reading speed.

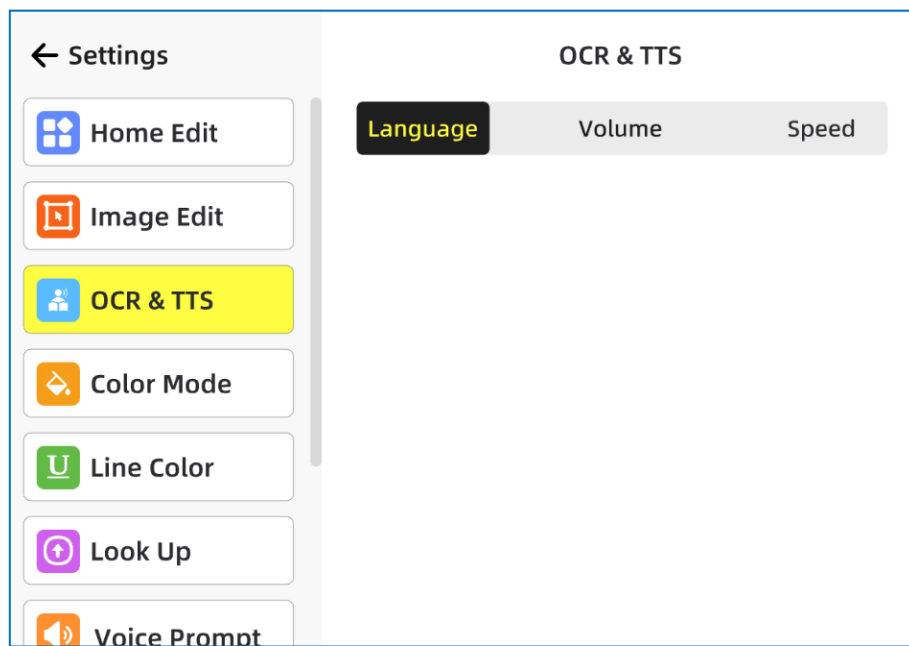

- Demo Video: Play the video to see a demonstration of the function.
- Color Mode: Choose to enable or disable some color mode.

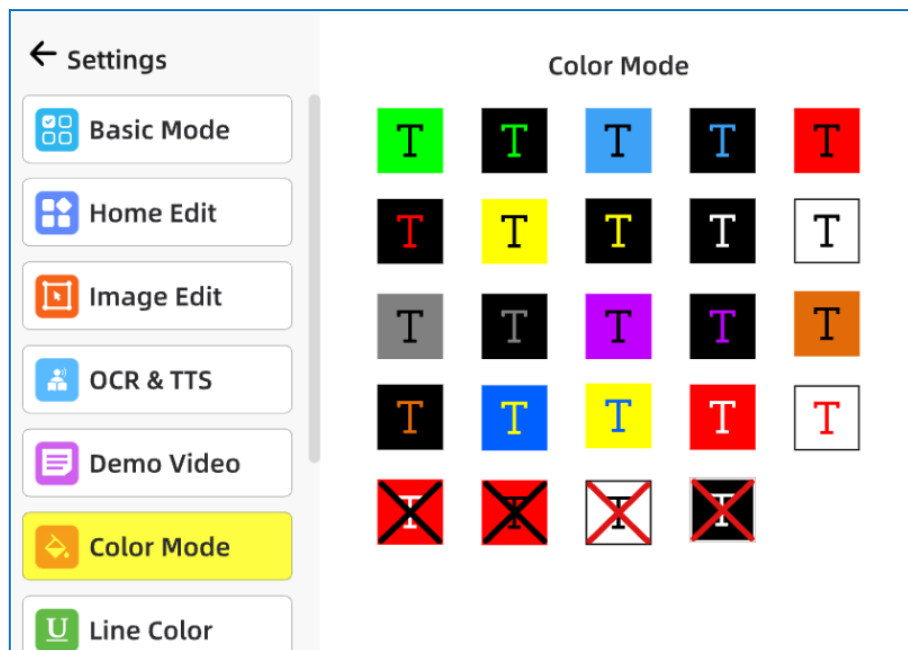

- Line Color: Choose one color for reading line.

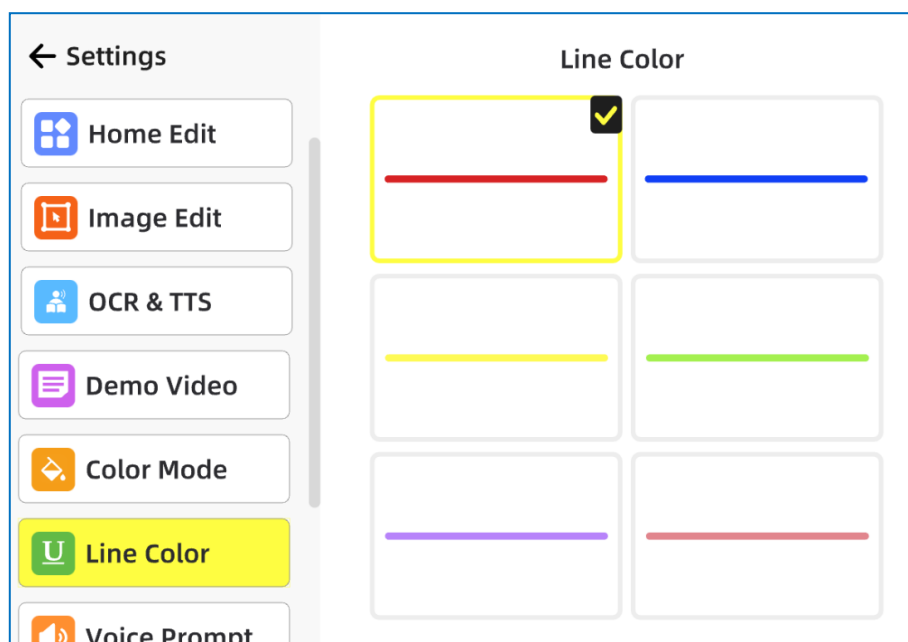

- Voice Prompt: With this function enabled, a corresponding voice plays, prompting the current status and functions every time when you tap an icon. And you can disable it if you don't need it.
- Frequency: Support for selecting appropriate local frequency.

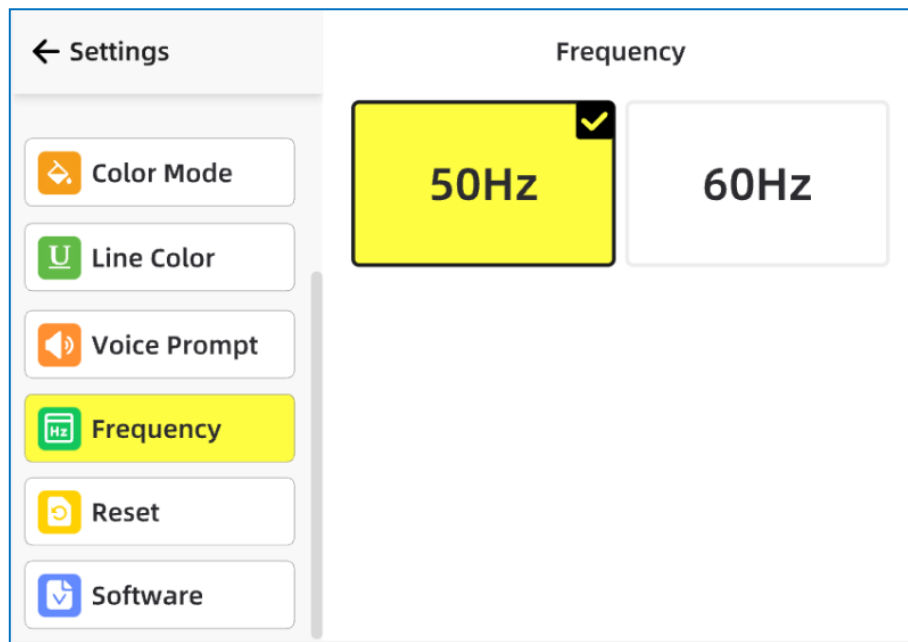

- Reset: Reset all the settings to default factory value.
- Software: Display the current software version.

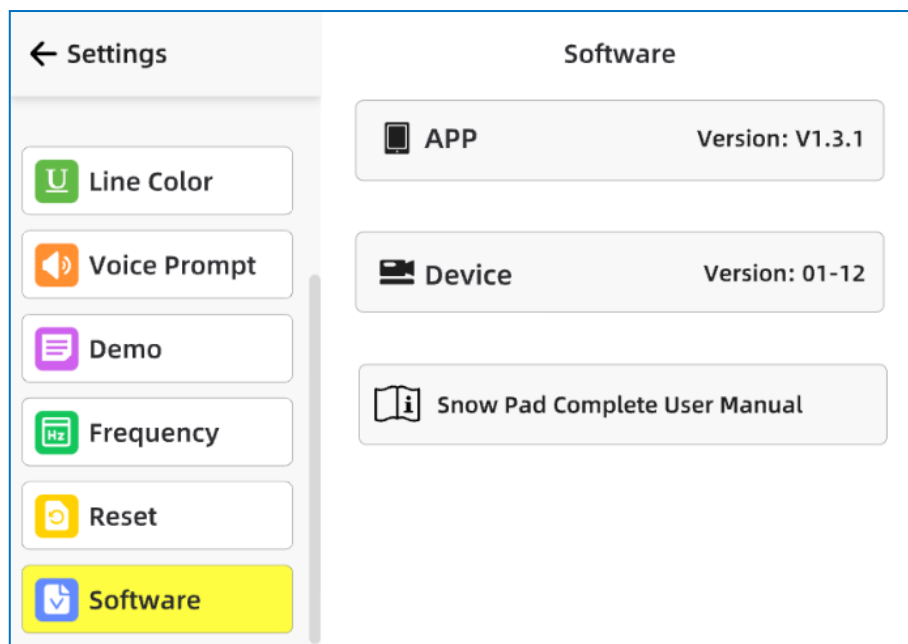

- Distortion Correction

This feature is enabled by default status within the app and is often used under near view of tablet's camera, such as looking at a book or magazine on a table, to reduce the reading impact of trapezoidal distortion.

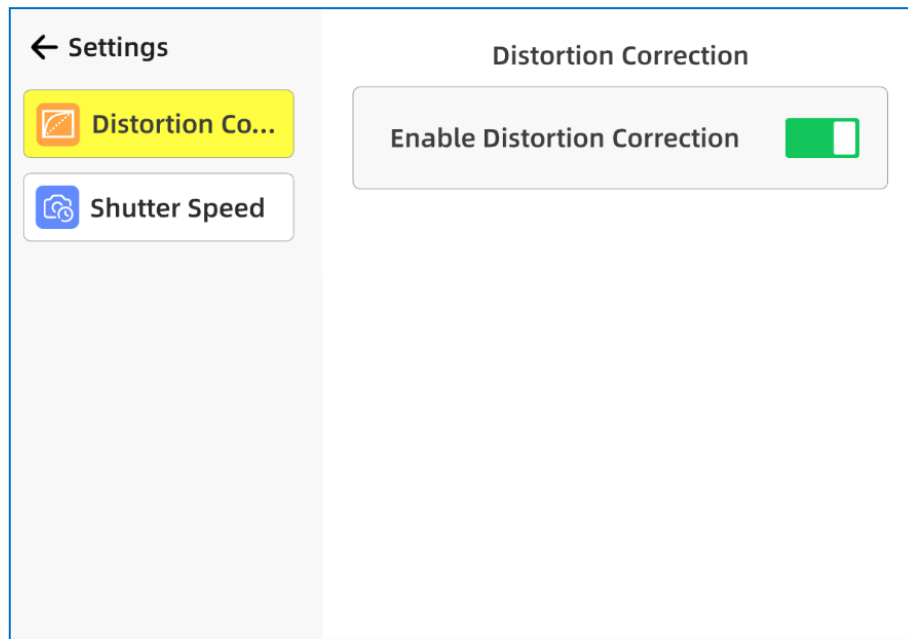

● Shutter Speed

You can adjust the shutter speed of the optical zoom camera, which is the factory default and suitable for most conditions. If you find abnormalities in the picture under special circumstances, such as horizontal lines, you can try changing the shutter speed to adjust it.

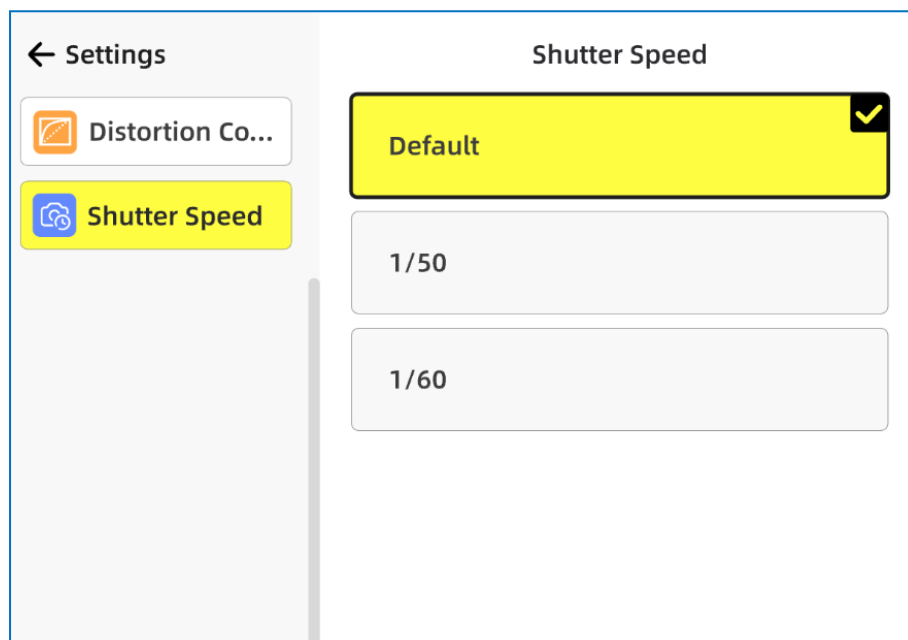

● Interface

There are two theme colors to choose from, mainly on the the icons of

main page, OCR page, and the image editing page.

Option 1 is our classic yellow and black color scheme, and option 2 is a color scheme. When you open the APP for the first time, option 1 is selected by default.

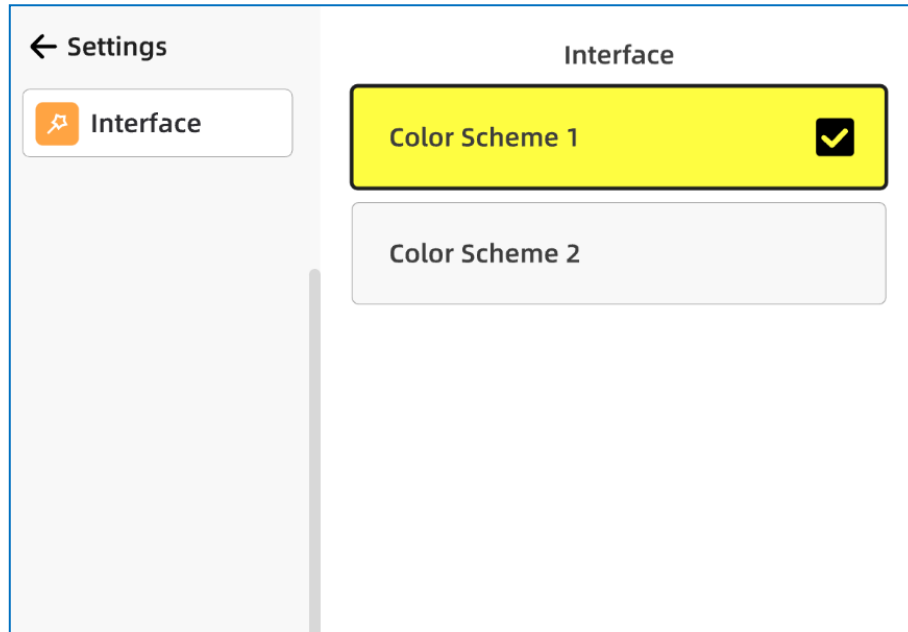

6. Software Update

- Snow Pad device: Update for dealer only.

For iPadOS:

V01-08 to V01-09 needs USB cable to connect the camera to the PC and then copy the software package for firmware version upgrade. Versions after 01-09 support OTA updates within the app.

For Android:

V01-06 to V01-12 needs USB cable to connect the camera to the PC and then copy the software package for firmware version upgrade. Versions after 01-012 support OTA updates within the app.

● Snow Pad APP:

For iPadOS: Online update in APP Store.

For Android: Download the package from the ZOOMAX official website.

7. Specifications

- Magnification: 1-32x
- Color Mode: 10 high-contrast color modes
- Folding Size: LWH 309*312*55mm
- Stand Height: 278mm
- Camera: 7x optical zoom lens, auto focus, 1920*1080, 60FPS
- Weight: approx. 2.4kg/5.29lbs
- Battery Life: ~5h
- Charging time: ~4.5h
- Adapter: input 100-240V; output 5V/3A

8. Trouble shooting

① Why the device cannot boot on after long pressing the power button?

--- Check the battery life and charge it for several minutes and try again.

② The indicator light near the charging port flashing yellow?

---It means the device is in a low battery and needed to be charged as soon as possible.

③ The device is connected to the tablet, but when it is turned on, a disconnection prompt is displayed within the APP.

---APP reboot; or re-plugging the connection cable between the device and tablet; or device reboot.

④ The image of Snow Pad distance view camera is blurry.

---Touch the screen to trigger focus manually; wipe the camera surface with the cleaning cloth.

⑤ The text in the APP is too small to read clearly.

---The font size within the app follows the tablet system and can be adjusted in the system settings.



















⑥ Black screen

---If there is no operation in the APP for 15 minutes, the device will enter sleep mode to save the power. Touch anywhere in the APP to wake up.

9. Service and Support

- Thank you for choosing our products, this product since the date of sale of the warranty period, the warranty period of two year. In the warranty period, where in accordance with the product instructions for normal use, the product itself quality problems arising from the failure, the company will be responsible for giving free maintenance.
- If you purchased this product through an authorized dealer, please contact them first for assistance and describe the problem you are experiencing in as much detail as possible.
- If you need additional accessories, such as adapters, please purchase them directly from your local dealer.

10. Certification and Compliance

| Symbol | Introductions | Symbol | Introductions |
|---|---------------------------------|---|--|
|  | CE Symbol |  | AUTHORISED REPRESENTATIVE IN THE EUROPEAN COMMUNITY |
|  | Manufacturer Address |  | Manufacture Date |
|  | Batch Code |  | Store in clean & dry place protected from rain, snow, ice, salt and water. |
|  | Warnings and Precautions |  | non-sterile |
|  | medical device |  | Use-by date |
|  | Keep dry |  | Keep away from Sunlight |
|  | Consult instructions for use |  | Unique Device Identification |
|  | Country of Manufacture |  | Model Number |
|  | Importer |  | Distributor |

European Authorized Representative:

| | |
|----|-----|
| EC | REP |
|----|-----|

Company: SUNGO Europe B.V.

Address: Fascinatio Boulevard 522, Unit 1.7, 2909VA Capelle aan den IJssel, The Netherlands

A- for Customer

Name

Tel

Mail

B -Product Information (for Distributor)

Product Name/Model

Purchase Date

S/N

ZOOMAX TECHNOLOGY CO., LIMITED
9F, Building D, Paradise Software Park,
No.3 Xidoumen Road, Xihu District, Hangzhou, Zhejiang
Province, 310012, China
Tel: +86-571-87006308
Fax: +86-571-87397220
Email: support@zoomax.com
Visit us at: www.zoomax.com

